

## OUTLINE DIMENSION

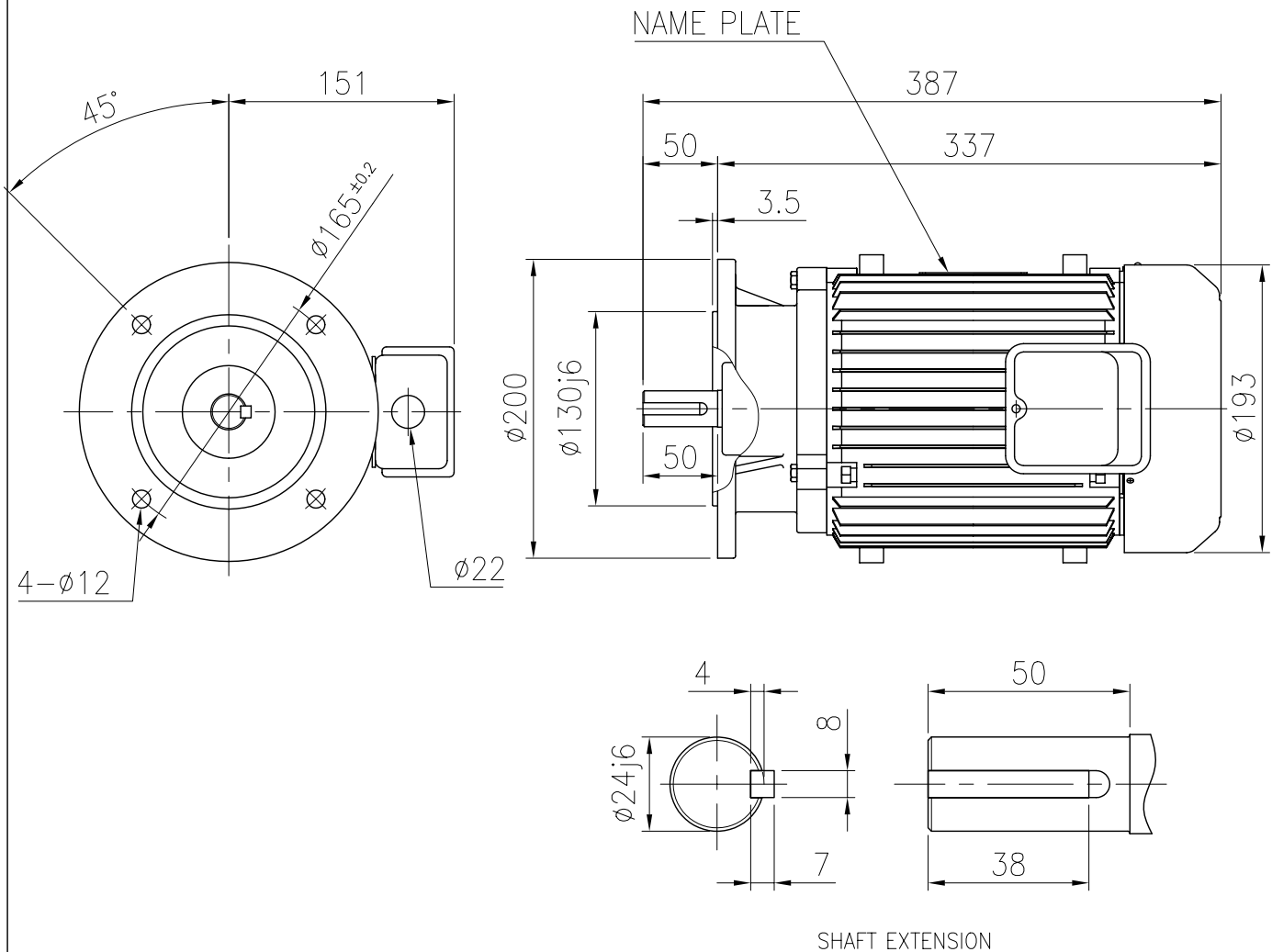

### <NOTE>

1. TYPE : TEFC(Totally Enclosed Fan Cooled)  
FOOTLESS MOUNTED TYPE
2. THE TOLERANCE FOR THE KEY DIMENSIONS  
IS IN ACCORDANCE WITH KS B 1311-84
3. THE TERMINAL BOX MAY BE ROTATED  
STEPS OF  $90^\circ$

4. ALUMINUM DIE CASTING FRAME AND  
CAST IRON END BRACKETS.
5. STAINLESS STEEL NAME PLATE
6. STEEL FAN COVER AND TERMINAL BOX.

FRAME NO.	OUTPUT (kW)				INS. CLASS	PRO-TEC-TION	RA-TING	BEARING NO.						APPROX. WEIGHT (Kg)		
								2 P		4 P		6P / 8P				
	2P	4P	6P	8P				DRIVE	OPP.D.	DRIVE	OPP.D.	DRIVE	OPP.D.	2P	4P	6P/8P
FF165	—	—	0.75	—	F	IP44	CONT.	—	—	—	—	6205ZZ	6204ZZ	—	—	20

UNIT	mm	SCALE	N S	PROJECT'N	3rd Angle	TITLE	OUTLINE
DESIGNED		CHECKED		APPROVED			
2006.09.20 H.G.HAN		2006.09.20 H.J.KIM		2006.09.20 H.T.KIM		SUBJECT	FF165, V1
Otis Elevator Korea						DWG. NO.	DW-KMB-01HK8F