

### OUTLINE DIMENSION

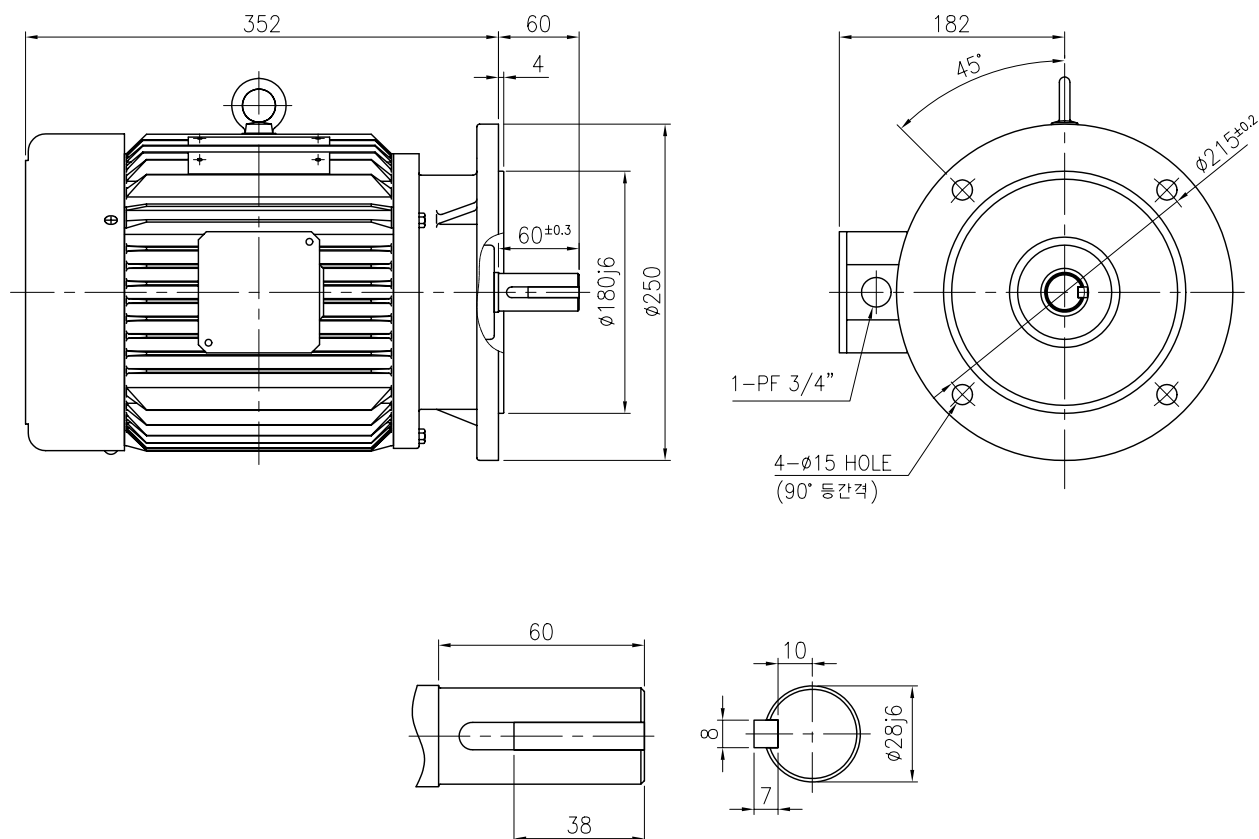

### SHAFT EXTENSION

#### <NOTE>

1. TYPE : TEFC(Totally Enclosed Fan Cooled)  
FOOT MOUNTED TYPE

2. THE TOLERANCE FOR THE KEY DIMENSIONS  
IS IN ACCORDANCE WITH KS B 1311-84

3. THE TERMINAL BOX MAY BE ROTATED  
STEPS OF 90°

4. CAST IRON FRAME AND END BRACKETS.

5. STAINLESS STEEL NAME PLATE WITH  
CONNECTION DIAGRAM.

6. STEEL FAN COVER AND AL TERMINAL BOX.

FRAME NO.	OUTPUT (kW)	POLE (P)	Hz	VOLTS (V)	INS. CLASS	PROTECTION	RATING	BEARING NO.		APPROX. WEIGHT (Kg)
								DRIVE	OPP.D.	
FF215	3.7	4	60	440	F	IP55	CONT.	6207ZZ	6205ZZ	48

UNIT	mm	SCALE	$\frac{N}{S}$	PROJECT'N	3rd Angle	TITLE	OUTLINE
DESIGNED		CHECKED		APPROVED			
2008.11.17 D.H.KAM		2008.11.17 J.H. JO		2008.11.17 H.J. KIM		SUBJECT	FF215, V1
HIGEN Motor co., Ltd.						DWG. NO.	DW-KMH05HV1F5