

OUTLINE DIMENSION

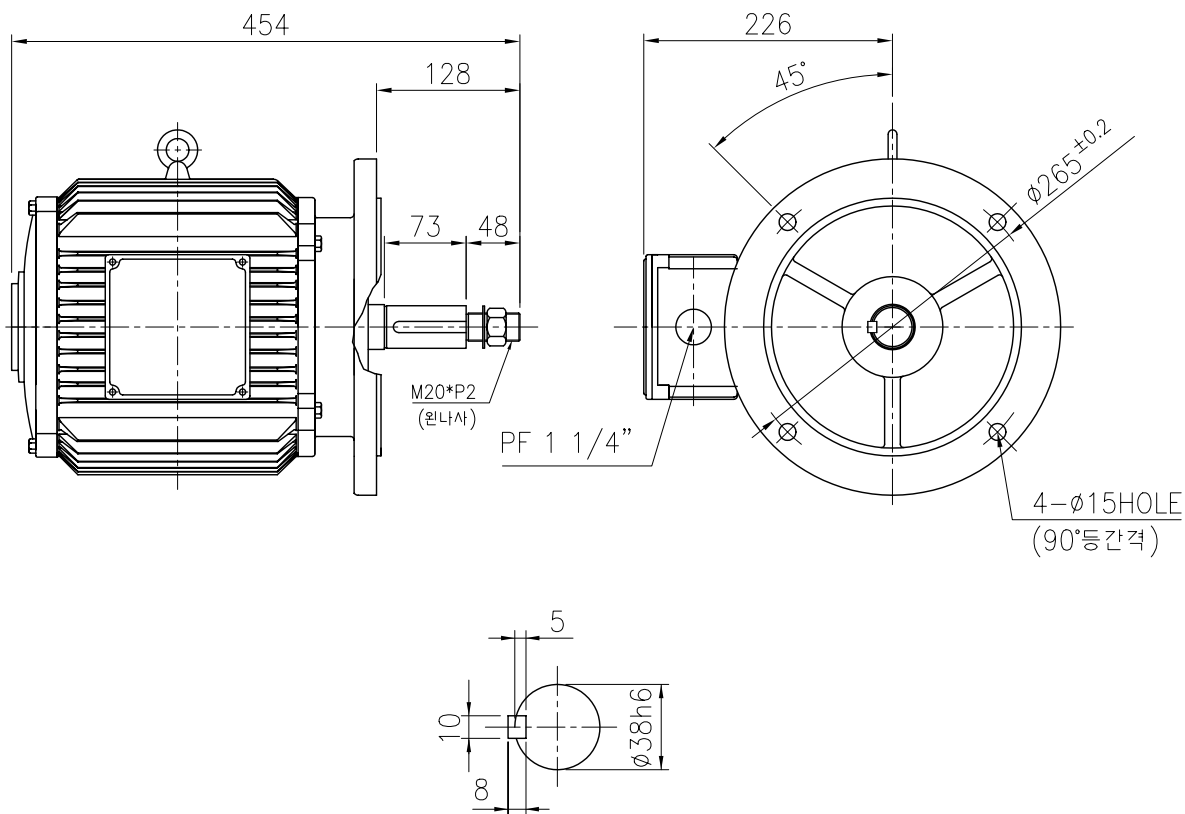

SHAFT EXTENSION

<NOTE>

1. TYPE : TEAO(Totally Enclosed Air Over)
FOOTLESS MOUNTED TYPE

2. THE TOLERANCE FOR THE KEY DIMENSIONS
IS IN ACCORDANCE WITH KS B 1311-84

3. THE TERMINAL BOX MAY BE ROTATED
STEPS OF 90°

4. CAST IRON FRAME AND END BRACKETS.

5. STAINLESS STEEL NAME PLATE WITH
CONNECTION DIAGRAM.

FLANGE NO.	OUTPUT (KW)			INS. CLASS	PRO- TEC- TION	RA- TING	BEARING NO.					
							2 P		4 P		6P	
	2P	4P	6P				DRIVE	OPP.D.	DRIVE	OPP.D.	DRIVE	OPP.D.
FF265	—	5.5	—	F	IP54	CONT.	—	—	6208ZZ	6206ZZ	—	—

UNIT	mm	SCALE	$\frac{N}{S}$	PROJECT'N	3rd Angle	TITLE	OUTLINE	
DESIGNED		CHECKED		APPROVED				
2008.06.03 S.M.KIM		2008.06.03 J.H JO		2008.06.03 H.J.KIM		SUBJECT	FF265	V1
HIGEN Motor co., Ltd						DWG. NO.	DW-I08HK1FWSH	